

# Mounting Channels

## Installation Guide

Installing Flexfire LEDs Mounting Channels is a straightforward process that can enhance the appearance, durability, and functionality of your lighting installation. Our channels are designed to ensure that your strip light lives a long life. By acting as a heat sink and providing a barrier from dust and debris, aluminum channels can extend the life of your strip light while also making maintenance simple. **Keep in mind that the order of operations for this installation guide may be different according to your specific project needs. Contact us if you have any questions.**

## Materials Needed

- Aluminum Channels and Covers



- End Caps



- Mounting Brackets or Clips



- LED Strip Lights



- LED Driver



- Measuring Tape, Painters Tape, and Pencil



- Miter Saw



- Screwdriver and Hex Tool



- Screws or Adhesive (for mounting)

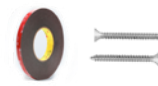

- Cleaning Solution



# Installation Instructions for Surface Mount Channels

## 1. Measure and Plan

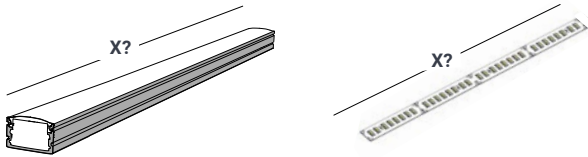

Determine where you want to install the LED strip light and aluminum channels. Measure the length of the channels and strip light needed to fit your desired space.

## 2. Cut Channels and LED Strips

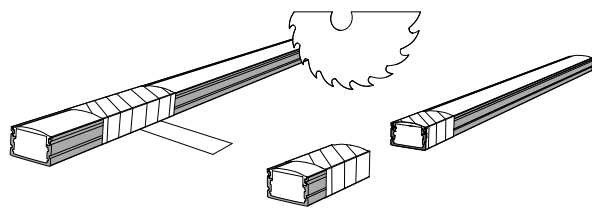

Cut the aluminum channels and covers to the desired length using a mitre saw or a cutting tool suitable for aluminum. Use painter's tape to secure the channel and the cover together to achieve a smooth seam line.

Please refer to our [LED Strip Light Installation Guide](#) for cutting and installing LED strip lights.

## 3. Mount the Channels



Position the channels where you want them to be installed. If your channels have mounting brackets or clips, drill an appropriately-sized hole on the flat surface where you are going to attach the channels. Using screws, attach the mounting brackets or clips in place, making sure they are level and aligned correctly. Mount the channels onto the mounting clips. You may also install the aluminum channels using double sided mounting tape, mounting glue or adhesive suitable for your surface.

## 4. Install the LED Strips

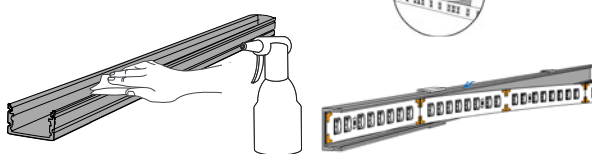

Clean any dust or dirt from the aluminum channels. Use rubbing alcohol or alcohol pads for optimal results. Insert the strip light into the channels by peeling the cover of the 3M tape backing a few inches at a time, while gently pressing the strip light to the channel. Ensure that the strip light is snugly fitted into the channel, so it won't fall out.

## 5. Insert Covers and Attach End Caps

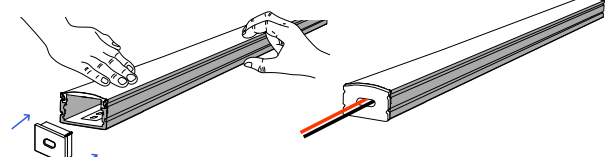

Insert the tip of the cover into the extrusion. Then, gently press down on different sections of the cover without bending or breaking it. If your aluminum channels come with end caps, snap or slide them onto the open ends of the channels to provide a finished look and protection for the strip light. Use the open end caps to run power cables out of the channel and the closed end caps to complete runs.

## 6. Wire the LED Strips and Test the Installation

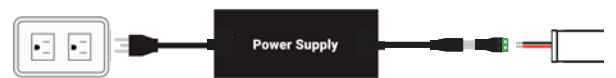

Connect the strip light to the LED driver. Please refer to our [LED Strip Light Installation Guide](#) and the manufacturer's installation instructions for the particular LED driver you have. Connect the LED driver to power to verify that the strip light is functioning correctly. Troubleshoot if needed.

## 7. Secure the Wires (Optional)

Use cable clips or adhesive-backed clips to secure the wires along the channels or nearby surfaces, keeping them neat and organized.

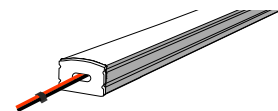

## 8. Enjoy Your Installation

Turn on your LED strip lights and enjoy your newly installed, well-lit space. Remember to follow all safety precautions and the specific instructions provided by the manufacturer of your LED strips, aluminum channels, and associated components throughout the installation process.

### NOTE:

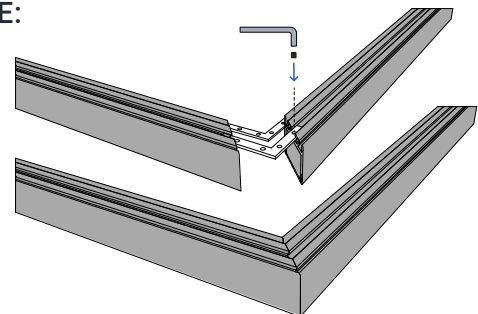

Some aluminum channels come with channel connectors. To install the aluminum channels using the channel connectors simply slide the channel connectors into the grooves on the back of the aluminum channel and use the black set screws to secure the channel connectors in place. It is easier if you secure the channel connectors on one channel first and continue with the other..

# Installation Instructions for Pendant Mount Channels

## 1. Install the Channel Fastener

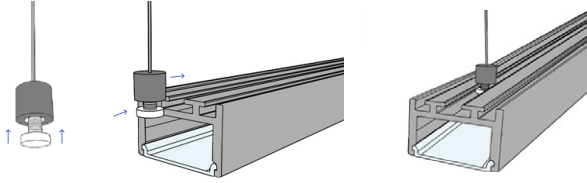

Attach the black screws into the base of the pendant mount channel fastener. Then, insert the base of the screw into the grooves on the back of the channel and slide them until secured in place.

## 2. Install the Ceiling Fasteners

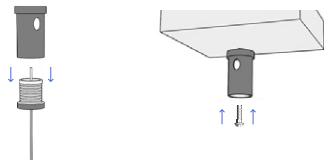

2.1: Unscrew the base of the ceiling fastener. Attach the ceiling fastener to the surface where you want to install the pendant fixture using the appropriate screw based on your surface.

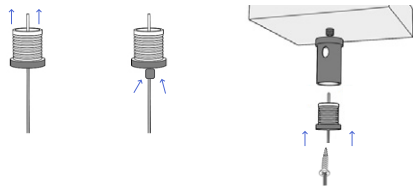

2.2: Adjust the length of your cable by pulling the cable from the top. If you need to re-extend the cable, push the retractable cylinder on the base of the ceiling fastener and pull the cable down. Once the desired length of cable is achieved, screw in the base of the ceiling fastener.

## 3. Finish Wiring Your Pendant Fixture

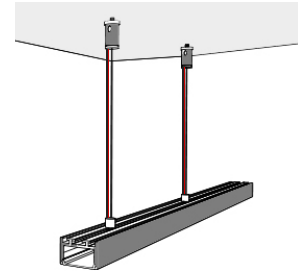

Please keep in mind that the cable is non-conductive of power. Run power wires parallel to the pendant cable as needed.

## 4. Enjoy Your Installation

Turn on your LED strip lights and enjoy your newly installed, well-lit space. Remember to follow all safety precautions and the specific instructions provided by the manufacturer of your LED strips, aluminum channels, and associated components throughout the installation process.

### NOTE:

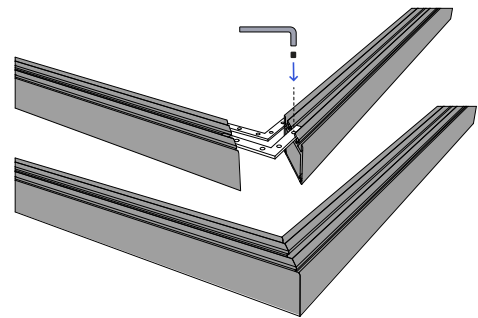

To install channel connectors simply slide the channel connectors into the grooves on the back of the aluminum channel and use the black set screws and secure the channel connectors in place using a hex tool. It is easier if you secure the channel connectors on one channel first and continue with the other.