

Leona™

Smart Home Controller

User Manual





FLEXFIRELEDs

www.flexfireleds.com

✓ **Features**

- 

For use with WiFi connection via the Smart Life phone app
- 

Allows Multiple Users Simultaneously
- 

5-100% Stepless Dimming
- 

Scene Creation
- 

Timer Functionality
- 

Compatible with Google Home and Amazon Alexa smart home systems

✓ **Parameters**

SKU	CCT/Color	Voltage	Wattage	Current
LEO-SC-CTRL	W	12-24V DC	120W max. (12V) 240W max. (24V)	5A x 1 CH 10A max.
LEO-DYN-CTRL	DYN	12-24V DC	120W max. (12V) 240W max. (24V)	5A x 2 CH 10A max.
LEO-RGB-CTRL	RGB	12-24V DC	120W max. (12V) 240W max. (24V)	5A x 3 CH 10A max.
LEO-RGBW-CTRL	RGBW	12-24V DC	120W max. (12V) 240W max. (24V)	5A x 4 CH 10A max.
LEO-RGBDYN-CTRL	RGBWW	12-24V DC	120W max. (12V) 240W max. (24V)	5A x 5 CH 10A max.

✓ **Dimensions**

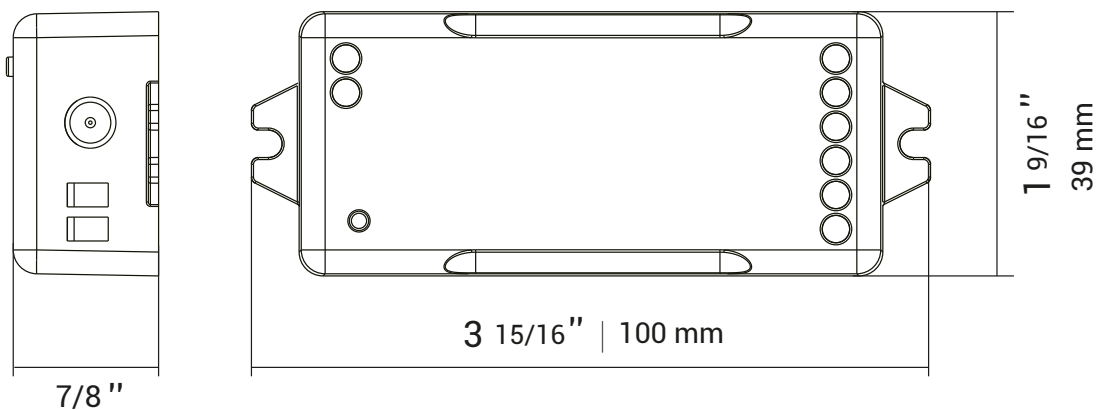

✓ **Wiring Diagram**

RGBW

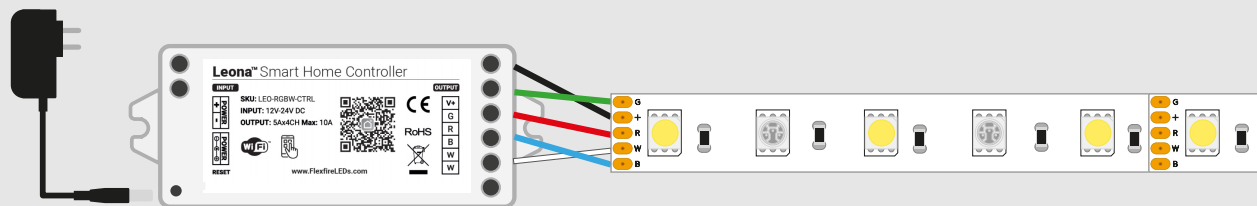

RGB

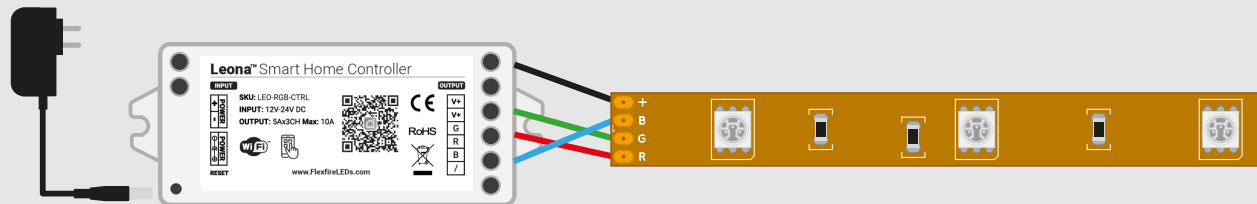

Single Color / Static White

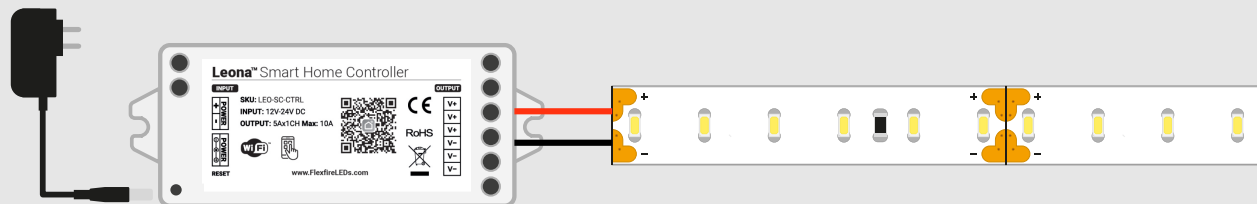

Dynamic Tunable White

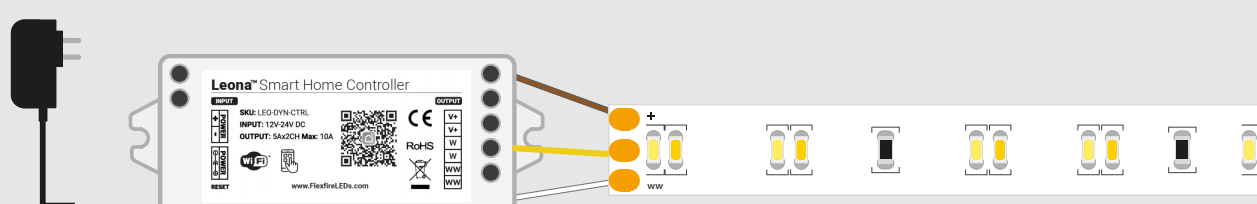

RGB + Dynamic Tunable White

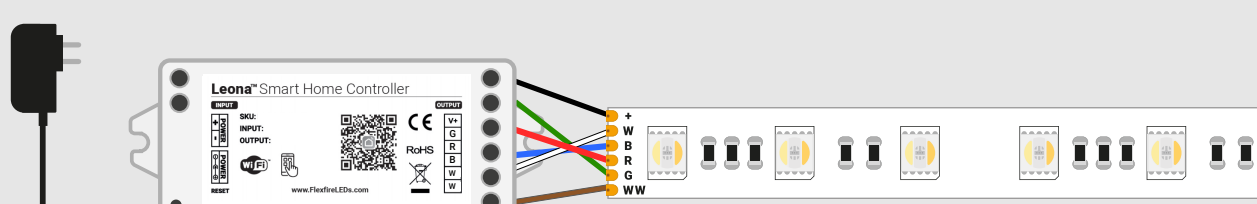

✓ Wiring Diagram

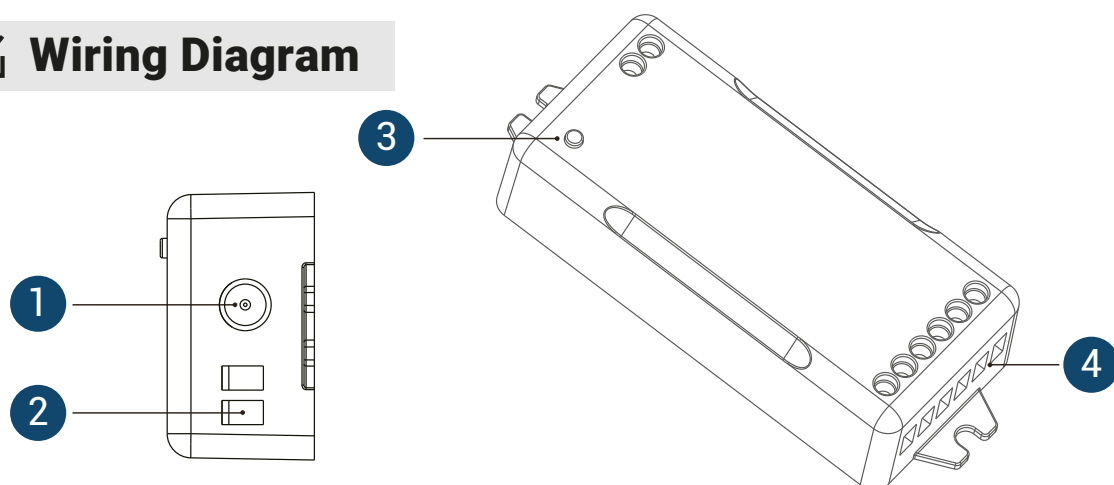

- 1 DC Port Input, DC 12V-24V
- 2 Hardwire Port Input, DC 12V-24V
- 3 Button Functions:
 - Switch ON/OFF
 - Press down for 5 seconds to reset the unit or enter pairing mode
- 4 LED Wire Terminal Ports

✓ Installation Instructions

- 1 Using a small screwdriver, connect LED strip wires to the wire terminals on the right side of the controller, matching the markings on the strip light to the terminals on the controller.
- 2 Ensure that the power supply is unplugged from the wall, then connect the power supply's output to the appropriate input port on the left side of the controller.
- 3 Once all connections are secure, plug in the power supply to turn the light on.
- 4 After functionality is confirmed, the controller can be adhered to a clean surface using the included 3M adhesive pad or mounting screws.

✓ Caution

- Do not place the controller in any kind of metal enclosure.
- Ensure the power supply and LED strip light are using the same operating voltage.
- Do not place anything on or around the controller, power supply or strip light that is not intended to be used with the system.
- Do not place in or around water or in a high humidity environment. Intended for indoor use only.

☑ Download Phone App

- 1 Search for the “Smart Life” app from the IOS App Store or Google Play Store.



- 2 Scan the QR code from the product label or user manual below.



Android 4.0



iOS 8.1

*The app is compatible with Android 4.0 and IOS 8.1 and higher

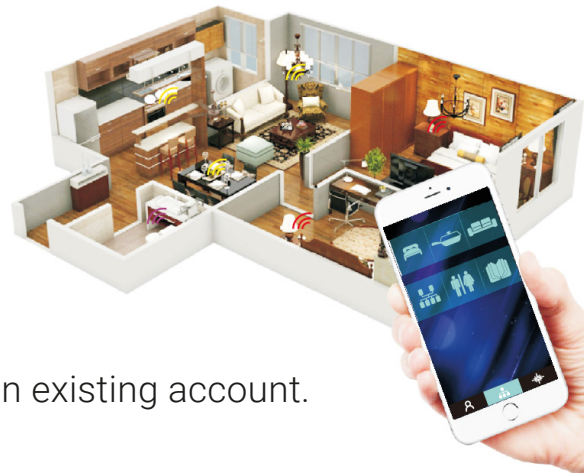

☑ Log In/Register Account

- Open the Smart Life app.
- Sign up for a new account or log in with an existing account.

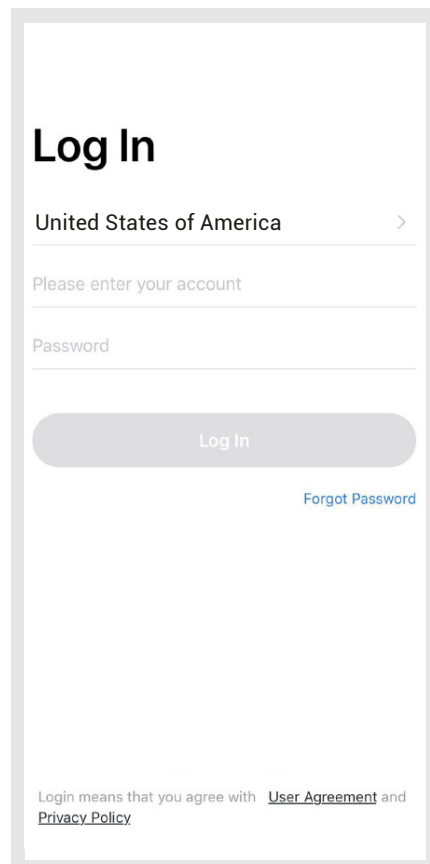
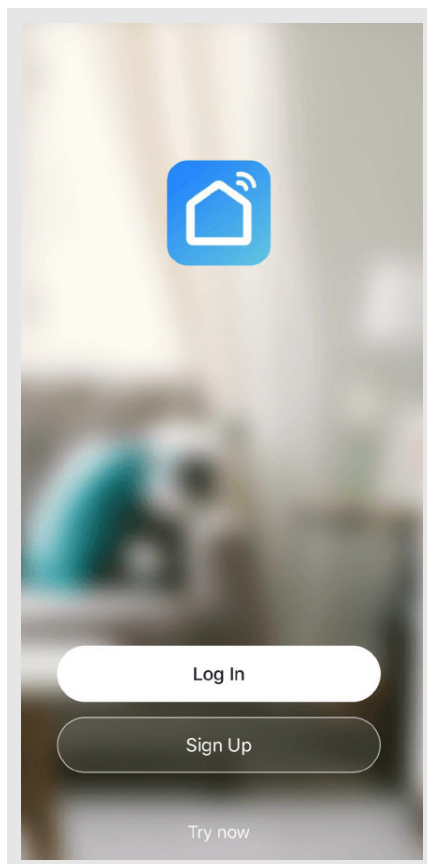

☑ Connect to the App

- 1 Apply power to your controller and light strip. Once connected to WiFi, ensure that you have a good signal and follow the prompts on the app.
- 2 The LED strip will flash when power is applied. Follow the prompt to add a new smart device by either manually adding the product or allowing the app to scan for a new device over WiFi.
- 3 If the LED strip is not flashing when power is applied, press down on the “Reset” button for more than 5 seconds. While the strip flashes, this is the time to add your device to the app.

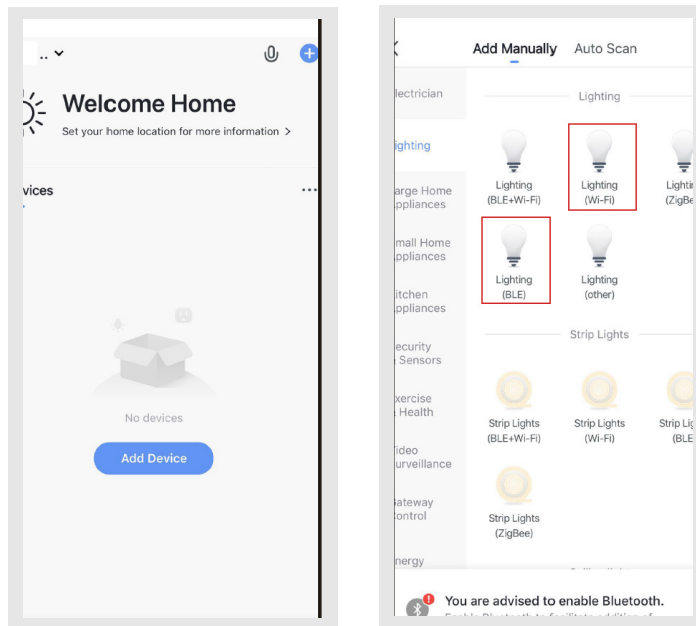

- 4 Please confirm that the phone and controller are using the same WiFi network and that the WiFi being used is a 2.4G signal. If the WiFi signal is in 5G mode, click “Compatibility Mode” in the upper right hand corner of the “Confirm the Light Flashing” screen.
- 5 Select the WiFi network connected to the smart device and input the WiFi password. Click “Next” to continue pairing the device.

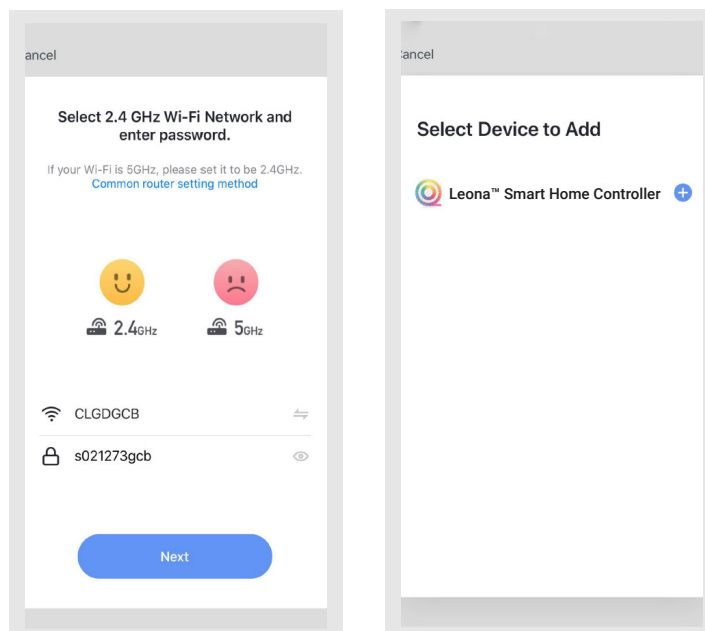

- 6 Once pairing is complete, you are now able to pair your smart home controller with third-party smart home apps such as Google Home and Amazon Alexa. Within the Smart Life app, however, there are a variety of functions such as dimming, scene control, timers, account sharing and more. Functionality will depend on the model of controller and strip that you have purchased.

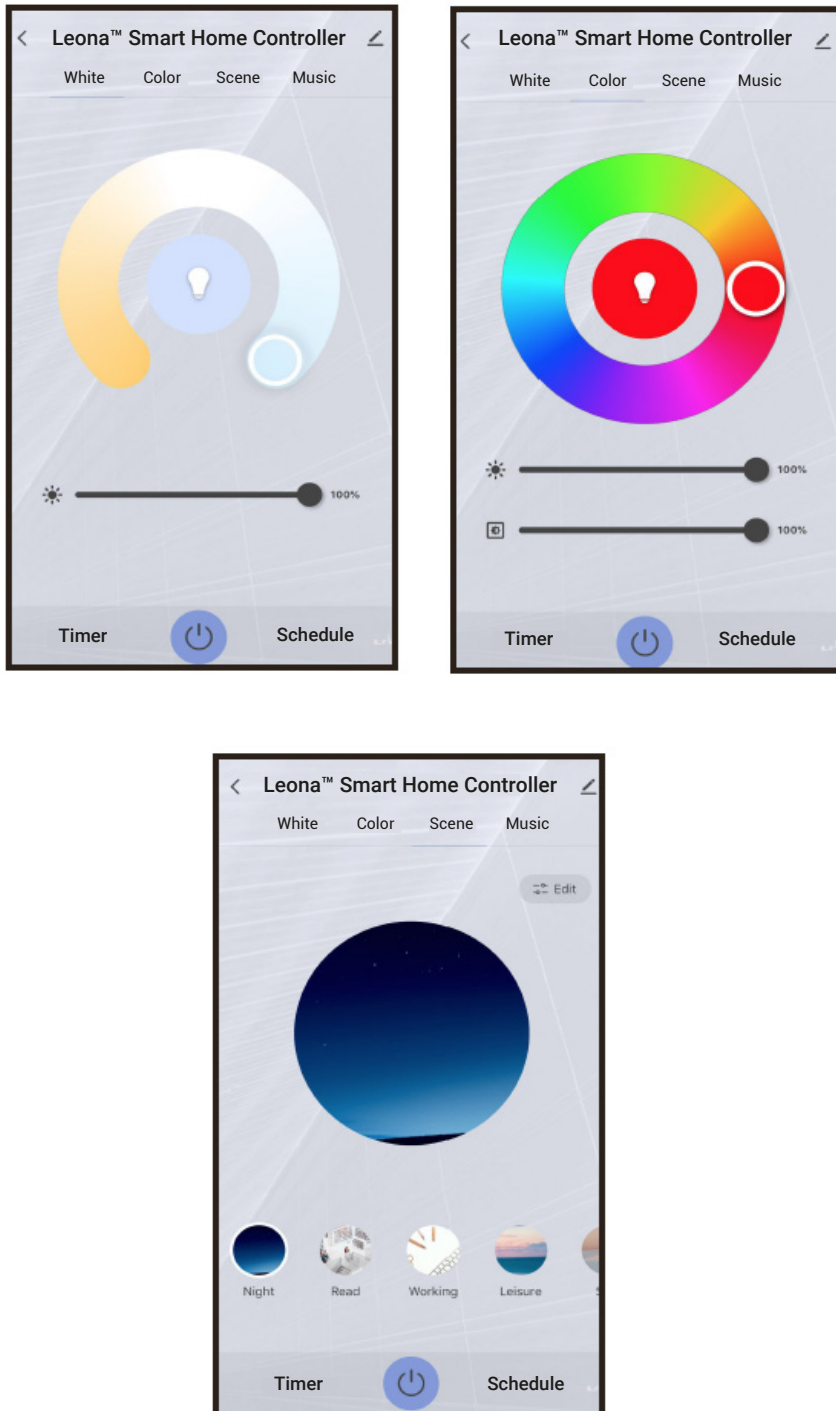

Warranty Information

Limited Warranty:

This product has a 2-year limited warranty from the date of shipment. This warranty only includes the main product outlined in this specification sheet and does not include the additional accessories that are used as a reference. Complete warranty details for fixtures and additional accessories are available at: **<https://www.flexfireleds.com/warranties/>** within the Policies section. For warranty-related questions please contact the product support team at **support@flexfireleds.com**

Consumer's Acknowledgment

Flexfire LEDs, Inc. stands behind its products when they are used properly and accordingly to our specifications. When you purchase our products, you are agreeing to the terms and conditions outlined in our warranty section. We try our best to make recommendations, but the burden of proper installation, design, and maintenance relies on the purchaser. This limited warranty does not include product failures that are the result of: Not using a voltage-regulated power supply to connect the LED product or controls; Connecting LED products to the wrong output voltage; Improper connection of power supplies, LED products, or controls; Connecting LED products or controls directly to any AC power source if they are stated for DC only input; Connecting power supplies backwards to an AC power source; Products used in an inappropriate location or in environmental conditions (temperature, humidity, moisture, etc.) outside the normal specified range; Water damage to products not specifically sold as waterproof products; Electrical power surges and spikes; Damage from hail, flooding, tornado, fire, wind, earthquake, lightning, electrical storm, or any other natural disasters or “force majeure” incidences; Damage caused by a vehicle or other accident; Damage caused when transporting the item; Damage to any products that were modified by the user, used for purposes other than as intended or directed, or connected to LED systems or components not purchased from Flexfire LEDs; Products that have been subjected to misuse, mishandling, misapplication or accident. Products used in connection with any components, devices or systems other than those explicitly approved as compatible with Company's products and listed on Company's website. Excessive wear and tear and/or physical or accidental abuse, loss, or theft. Improper repairs or warranty services performed by someone other than Flexfire LEDs will void this warranty.



Toll Free Number:
1-844-353-9347



Local Number:
(925) 273-9080



support@FlexfireLEDs.com



FLEXFIRELEDs